

How to update the firmware for Cutting Plotters

The firmware of Cutting plotters is able to update by the UPDATE.exe. This instruction is explaining by based on the WINDOWS 11 menus.

1. Preparations before the firmware update

- (1) Unzip the firmware update file with your PC.
- (2) The following files are contained in the firmware update files for each model.

Model	Firmware file	Update EXE file	DLL file	Manual file
CE8000 series	CE8000_V***_R****.x	UPDATE.EXE	GITKPRNP.DLL	How to update firmware for Cutting plotters.pdf (This instruction manual.)
CE8000-40+ASF1				
CE8000-130AP	CE8000AP_V***_R****.x			

(The “*” of firmware file name is showing the version number and the revision number.)

Note: The plotter will not be guaranteed if this "UPDATE.EXE" and other files are edited by the editing software.

Do not edit the "UPDATE.EXE" and other files.

To use this, the plotter driver must be installed.

2. How to update the firmware (When using USB flash drive)

Disconnect the USB cable and LAN cable and make sure that the cutting plotter and PC are not connected.

Never turn off the power to the cutting plotter until the firmware update is complete. Also, never remove the USB flash drive.

Procedure

- (1) Save only one firmware file (***.x) of the model to be updated to the USB flash drive.
Recommended: Please save the firmware file (***.x) after deleting all folders and files in the USB flash drive.
- (2) Make sure that the cutting plotter is turned off, then insert the USB flash drive into the cutting plotter.
- (3) Turn on the power while simultaneously pressing the left and right keys on the control panel of plotter.
- (4) When the message "Press ENTER key to start update" is displayed on the control panel of plotter, take your fingers off the keys.

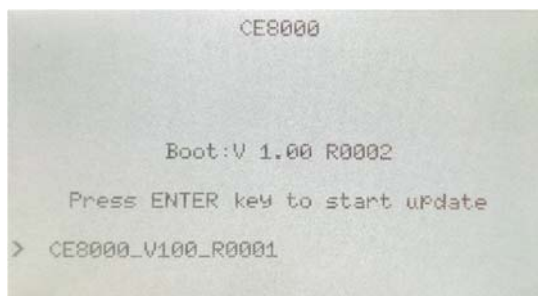

- (5) Press the "ENTER" key on the control panel of cutting plotter.
- (6) The progress of the firmware update will be displayed, so wait for the update to complete.

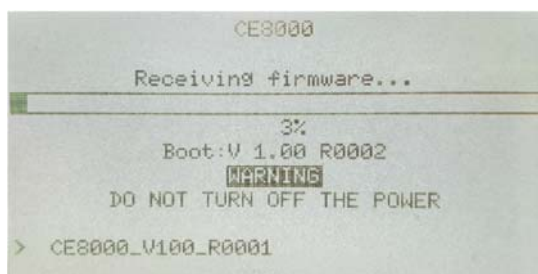

- (7) Confirm the updating situation on the control panel of cutting plotter.

- (8) The plotter will be initialized automatically after the firmware was updated.
 - (9) Confirm the firmware version, the firmware version is displayed, when the cutting plotter is initializing.
- End

3. How to update the firmware (When using application : UPDATE.EXE)

Confirm the Cutting Plotter and the PC are connected via the USB cable. And confirm the Cutting Plotter is ready to use via the USB port. (The firmware is not able to update via the LAN port.)

To use this, the plotter driver must be installed.

Please exit from the Cutting Software when the Cutting Software is running on the PC. When the Cutting Software is running, the firmware update is not able to perform correctly.

Procedure

- (1) Connect the Cutting Plotter and the PC via the USB cable, and then turn on the power for the cutting plotter. Confirm the “Ready” or the “Media selection” menu is displaying on the control panel of plotter.
- (2) Double click the “UPDATE.EXE” to run the updating software.

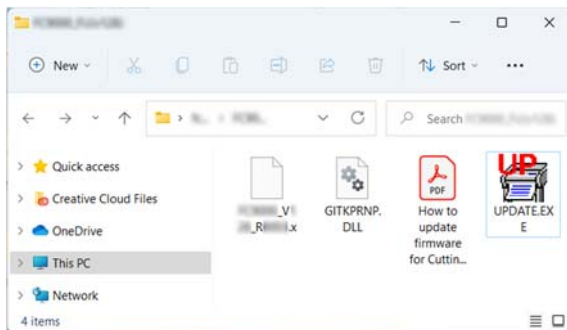

- (3) The following menu is shown when the “UPDATE.EXE” started. Click the OK button after confirmed the Cutting Software is not running.



- (4) The following menu is displayed.

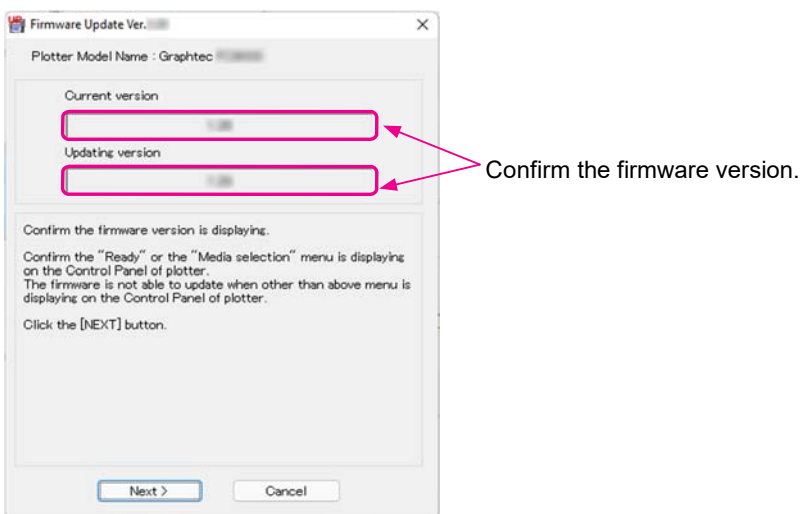

- (5) Confirm the current firmware version of cutting plotter and the updating firmware version at above menu. The error will be displayed if these firmware are not matching with the plotter connected. Confirm the connecting cutting plotter and firmware if the error was displayed.

- (6) Confirm the “Ready” or the “Media selection” menu is displaying on the control panel of plotter.
- (7) Click the NEXT button.



- (8) Click the Update button.



- (9) The following menu is displayed during sending the firmware to the cutting plotter.
Don't turn OFF the power for the cutting plotter when the firmware is sending to the cutting plotter. Don't unplug the USB cable from the PC and the cutting plotter when the firmware is updating.



- (10) The following menu is displayed when the firmware had been sent.

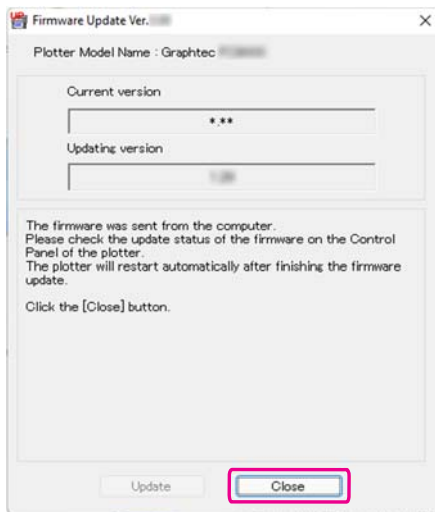

- (11) Click the Close button to exit the Firmware Update software.
(12) Confirm the updating situation on the control panel of cutting plotter.
(13) The plotter will be initialized automatically after the firmware was updated.
(14) Confirm the firmware version, the firmware version is displayed, when the cutting plotter is initializing.

End